

# SCUBAPRO

Technical Service Schematic

BALANCED ADJUSTABLE  
ADJUSTABLE SECOND STAGE

#11-15X-000  
#11-109-000

Date 12/97      Revision R  
Annual Repair Parts Kit #11-254-041  
#11-200-041

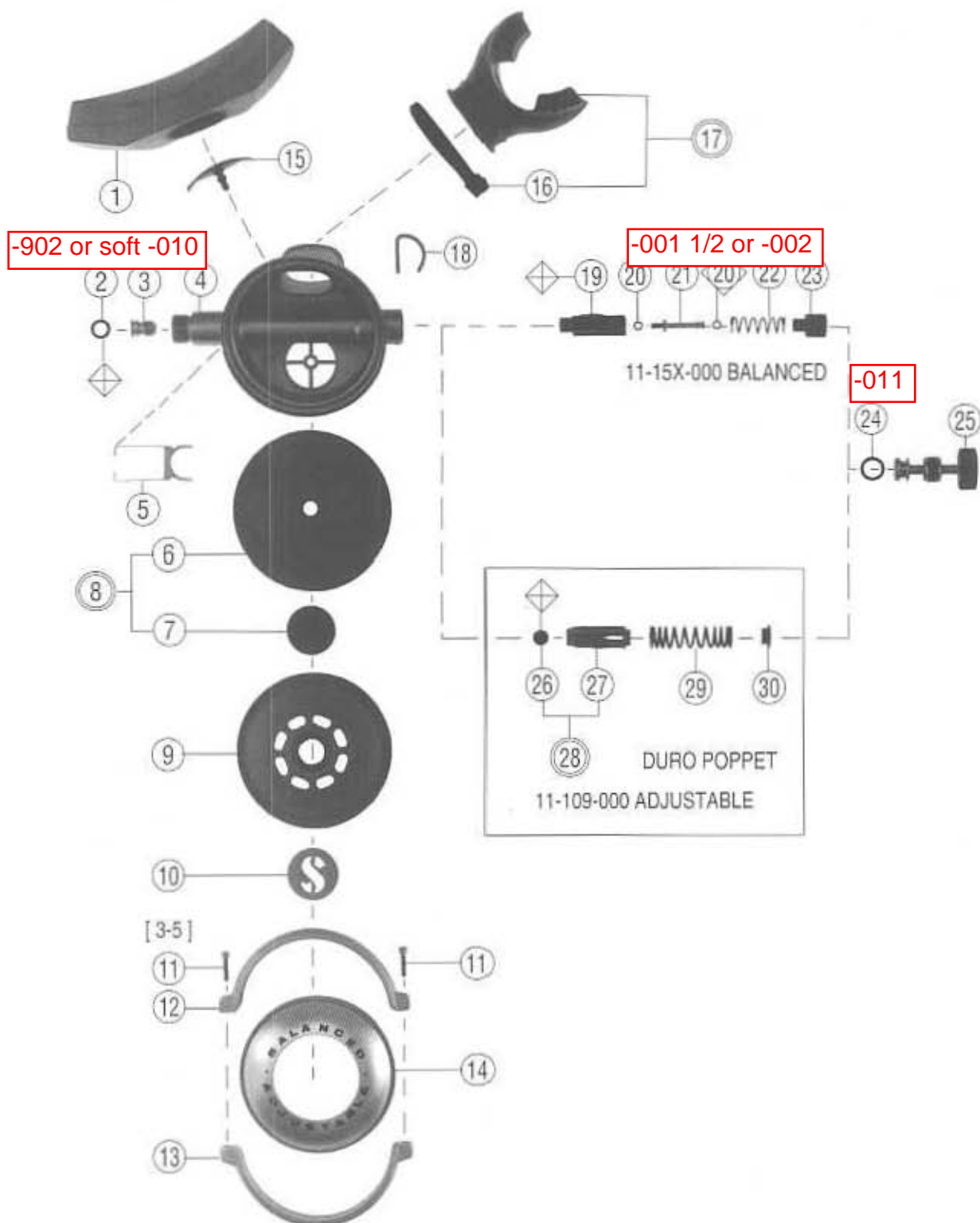

# SCUBAPRO

Technical Service Schematic

**BALANCED ADJUSTABLE #11-15X-000**  
**ADJUSTABLE SECOND STAGE #11-109-000**

## Parts

| #                              | QTY | PART #     | DESCRIPTION                   | COST |
|--------------------------------|-----|------------|-------------------------------|------|
| 1                              | 1   | 01-043-102 | EXHAUST TEE, BLACK            |      |
| 2                              | 1   | 01-050-293 | O-RING, RED                   |      |
| * 3                            | 1   | 11-109-109 | ORIFICE                       |      |
| 4                              | 1   | 11-109-002 | CASE ASSEMBLY                 |      |
| * 5                            | 1   | 11-109-105 | LEVER                         |      |
| 6                              | 1   | 11-109-124 | DIAPHRAGM, BLACK              |      |
| 7                              | 1   | 11-109-123 | DISC, DIAPHRAGM               |      |
| 8                              | 1   | 11-109-011 | DIAPHRAGM ASSY                |      |
| 9                              | 1   | 11-109-106 | COVER, RUBBER                 |      |
| 10                             | 1   | 01-005-101 | INSIGNIA PLATE                |      |
| 11                             | 1   | 01-101-128 | SCREW, SOCKET HEAD            |      |
| 12                             | 1   | 11-108-110 | CLAMP, UNTHREADED             |      |
| 13                             | 1   | 11-108-109 | CLAMP, THREADED               |      |
| 14                             | 1   | 01-150-105 | COVER RING, BALANCED          |      |
| ● 0                            | 1   | 11-108-108 | COVER RING                    |      |
| 15                             | 1   | 11-109-128 | EXHAUST VALVE                 |      |
| ▲ 16                           | 1   | 01-088-101 | STRAP, MOUTHPIECE, BLACK      |      |
|                                | 1   | 01-088-107 | STRAP, MOUTHPIECE, CRYSTAL    |      |
| ▲ 17                           | 1   | 01-040-010 | MOUTHPIECE, BLACK             |      |
|                                | 1   | 01-040-006 | MOUTHPIECE, CRYSTAL           |      |
| 18                             | 1   | 11-109-121 | RETAINING CLIP                |      |
| 19                             | 1   | 01-150-003 | POPPET ASSY, BALANCED         |      |
| 20                             | 2   | 01-050-399 | O-RING, POPPET STEM, BLACK    |      |
| 21                             | 1   | 01-150-103 | STEM, POPPET                  |      |
| 22                             | 1   | 01-020-216 | SPRING, BALANCED POPPET       |      |
| 23                             | 1   | 01-150-102 | BALANCED CHAMBER              |      |
| 24                             | 1   | 01-050-138 | O-RING, ADJUSTMENT KNOB, BLUE |      |
| * 25                           | 1   | 11-250-009 | KNOB, ADJUSTMENT              |      |
| 26                             | 1   | 11-108-101 | SEAT                          |      |
| 27                             | 1   | 11-200-105 | DURO POPPET                   |      |
| 28                             | 1   | 11-200-014 | DURO POPPET ASSY              |      |
| 29                             | 1   | 01-020-109 | SPRING                        |      |
| 30                             | 0   | 11-109-104 | SPRING PAD                    |      |
| 31                             | 0   | 11-200-020 | G200 TO G200B BALANCE KIT     |      |
| 11-15X-000 BALANCED ADJUSTABLE |     |            |                               |      |
| 11-109-000 ADJUSTABLE          |     |            |                               |      |

Date 12/97 Revision R

Annual Repair Parts Kit #11-254-041

#11-200-041

## Technical Information:

The Annual Repair Parts Kit may contain o-rings used in the hose assembly. Refer to the separate hose schematic for identification.

Reference Item #6: The molded part number imprinted on the rubber diaphragm is 11-109-124.

## Special Engineering Notes:

Prior to installing the poppet, the orifice item #3 should be backed away from the poppet to avoid damage to the poppet seat.

To install the poppet, install the lever first into the slotted holes of the case assembly item #4. Hold the case upright and drop the poppet into the tube, so the tabs that project from the poppet are facing towards the mouthpiece. These tabs must engage into the legs of the lever to lift the poppet when the lever is depressed.

Lubricate all threads with silicone grease, especially those of the adjustment knob item #25 to reduce long term corrosion and provide easier disassembly at the next service interval.

## Legend (prices subject to change without notice)

● Not Shown ◇ Dynamic O'Ring Replace Annually

○ Optional Item ◆ Annual Replacement

▲ Limited Warranty [ ] Torque In Inch Pounds

□ Older Configuration \* See Note