

#	QTY	PART #	KEY	DESCRIPTION
1	1	0060-21		O-RING
2	1	0130-87		RETAINING SCREW
3	1	0110-01		FILTER
4	1	9803-00		GREEN LOCTITE® 290
5	1	0182-10		ADAPTOR
6	1	0060-01		O-RING
7	1	0560-22		KNOB
8			②	REGULATOR BODY
9	1	0960-06		DUST CAP
10	1	0621-13	②	YOKE SUPPORT
11	1	0182-26		SPACER
12	1	0623-36	①	SPACER
13	1	0721-84		DECAL

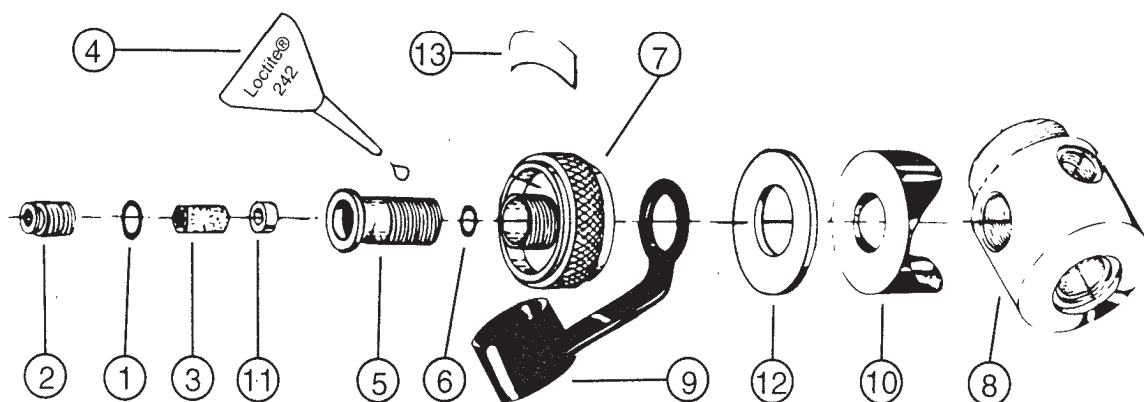

DIN CONVERSION KIT (P/N 1123-00)
FITS: 600, 900, 650, 950 & 760

9/93

DIN Kits & Regulator
Accessories

PAGE

3-3

KEY

① Used on 600, 650, 900 & 950 only.
② Not included in kit

DIN CONVERSION KIT (P/N 1123-00)**FITS: 600, 900, 650, 950 & 760****Pre-Assembly:**

Step 1: Disassemble yoke assembly from regulator body (8). This is accomplished by unscrewing the nut from the main body. Removal of the yoke nut will completely detach yoke assembly.

Step 2: make certain the bottom surface of the threaded hole in the body (8) is perfectly clean and without any imperfections, nicks or scratches.

Assembly:

Step 1: Lubricate the o-ring (6) with silicone grease, and place it in the groove in the face of the adaptor (5).

Step 2: Place the knob (7) on the adaptor stem (5) as shown. Then, put the dust cap on the outside of the knob (7), also on the stem of the adaptor (5). The dust cap (9) should cover and protect the threaded portion of the knob when the regulator is not in use.

Step 3: Place yoke support (10) over adaptor stem, (on 760 model only). On models 600, 650, 900 and 950 place spacer (12) over adaptor.

Step 4: Place one drop Blue Loctite® 242 (4) on the threaded portion of the adaptor, approximately in the middle of the exposed thread length, as shown in the drawing.

Step 5: The DIN assembly is now ready to be fastened to the regulator body. Lock the assembly in by using a wrench to ensure a tight seal.

REPAIR PROCEDURE	PAGE	DIN CONVERSION KIT (P/N 1123-00) FITS: 600, 900, 650, 950 & 760		
	3-4	DIN Kits & Regulator Accessories	9/93	