

#	QTY	PART #	KEY	DESCRIPTION
1	1	0180-05		RETAINER
2	1	0050-01		DIAPHRAGM
3	1	0120-65		WASHER
4	1	0180-04		AMBIENT CAP
5	1	0020-03		ADJUSTING SCREW
6	1	0040-06	①	SPRING PRE 1987
	1	0040-05	①	SPRING PRE 1987
	1	0040-53	②	SPRING POST 1987 (SUB 0040-57)
7	1	0160-00		SPRING PAD (SUB 0622-14)
8	1	0050-12		H.P. DIAPHRAGM
9	1	0860-04		SILICONE PASTE
10	1	0108-09		SILICONE LIQUID

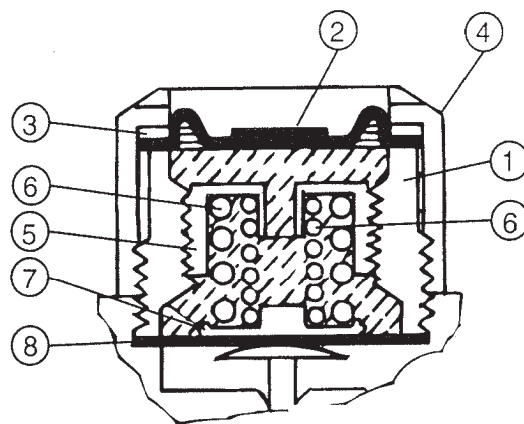

 SILICONE PASTE
 SILICONE LIQUID

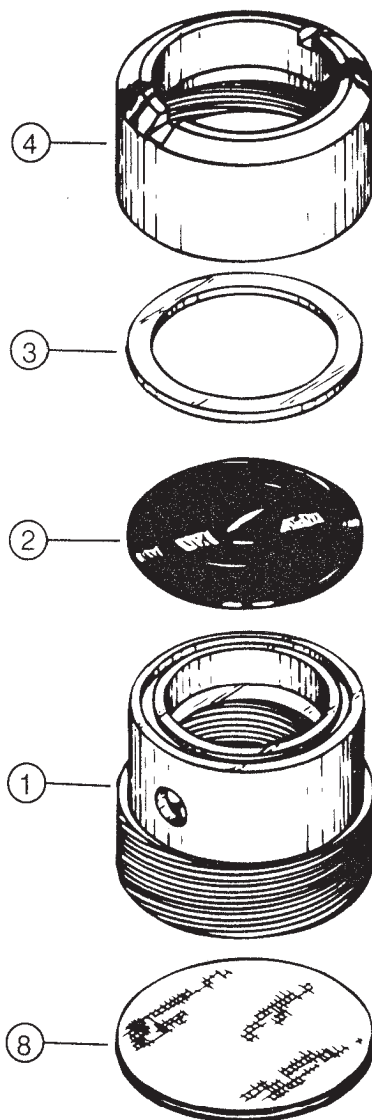

9. (0680-04) SILICONE PASTE

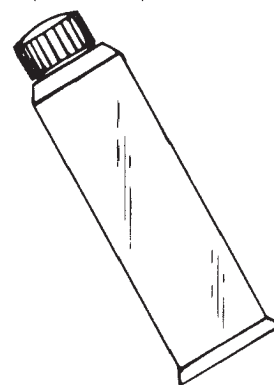

10. (0108-09) SILICONE LIQUID

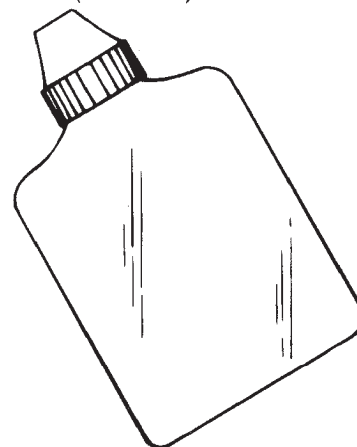

AER (ALL ENVIRONMENT REGULATOR)
KIT

9/93

DIN Kits & Regulator
Accessories

PAGE

3-1

KEY

① Dual spring combination pre 1987
 ② Single spring post 1987

AER (ALL ENVIRONMENT REGULATOR) KIT**Tools Needed:**

1. 0980-15 Spanner Wrench
2. 9935-00 Intermediate Pressure Gauge
3. Wide Blade Screwdriver

Installation:

Install thin H.P. diaphragm (8) and spring pad (7). Install pre 1987 dual springs or post 1987 single spring (6). Install retainer (1) using spanner wrench to ensure positive sealing against H.P. diaphragm (8). Install adjusting screw (5) making sure the screw is sitting properly on top of spring(s). Screw in adjusting screw approximately 2-1/2 turns using 3/4" blade screwdriver.

Intermediate Pressure Adjust and Final Assembly:

Step 1: Attach regulator to an air source with at least 1000 PSI supply pressure (dive tank or test board). Regulator should be mounted with the retainer (1) in the upright position.

Step 2: Connect intermediate pressure gauge to any low pressure port on the regulator.

Step 3: Pressurize regulator.

Step 4: Adjust intermediate pressure to 140 PSI by turning adjusting screw (5) clockwise to increase pressure, counterclockwise to decrease pressure.

Step 5: Fill chamber above H.P. diaphragm (8) with silicone liquid (10). Fill through adjusting screw (5) up to rim of retainer(1). (see illustration). Wait a few seconds for any air to be displaced and fill again.

Step 6: Fill convolution in diaphragm (2) with silicone paste (9) or silicone grease (9606-00).

Step 7: Place thick washer (3) (sharp side away from diaphragm) in the ambient cap (4).

Step 8: See illustration for replacement of diaphragm (2) in the cap (4). Install cap (4) on the retainer (1). Tighten with wide blade screwdriver.

Step 9: Recheck intermediate pressure. It should be between 138-144 PSI.

Step 10: Final check:

A) Depressurize system. If chamber has been properly

filled, the diaphragm (2) will contract inward and expand outward once repressurized.
B) Check for leaks.

REPAIR PROCEDURE	PAGE 3-2	AER (ALL ENVIRONMENT REGULATOR) KIT		
		DIN Kits & Regulator Accessories	9/93	