

# THERMO

## PRO Valve

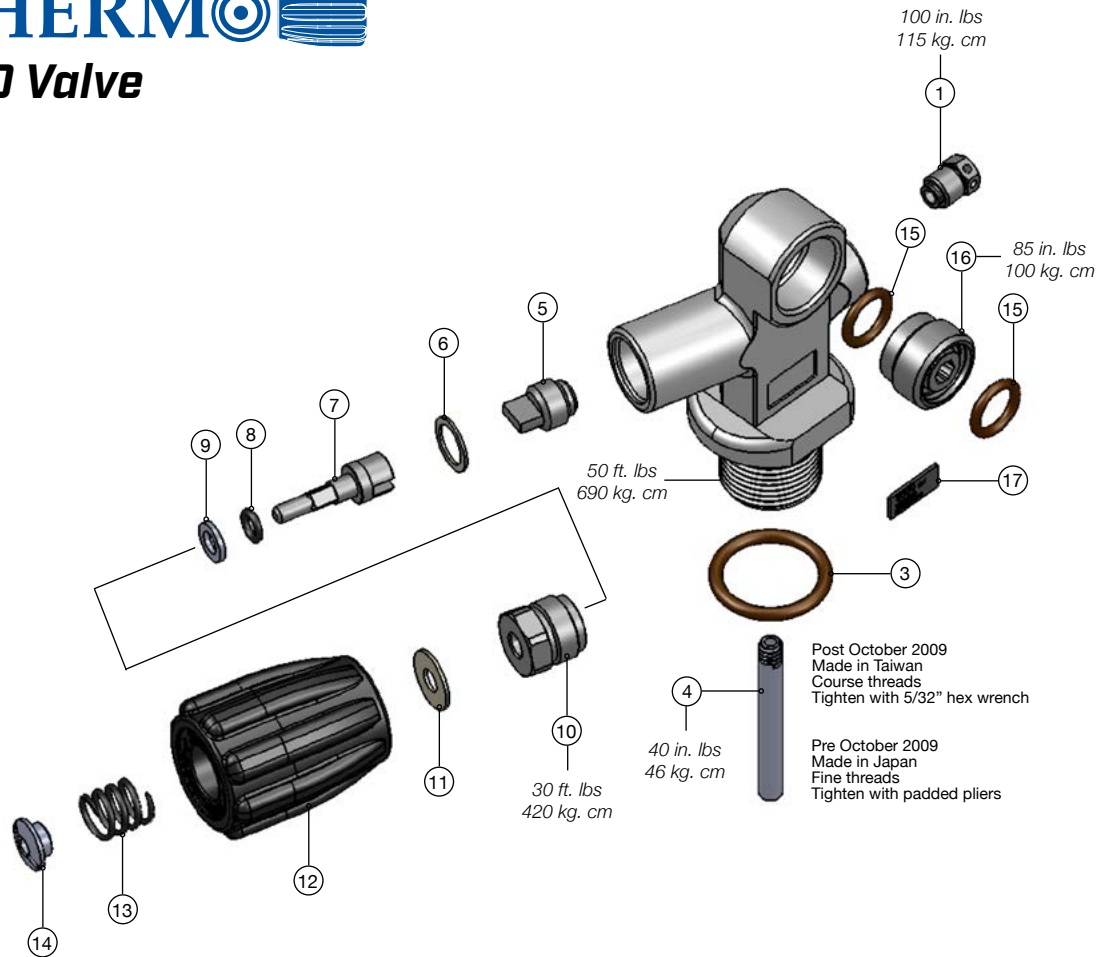

#	Part #	Description	#	Part #	Description
<b>VKT-P</b>			<b>SERVICE KIT - THERMO PRO VALVE</b>		
1	VP01-20	Safety Assembly - 2015 psi (3358 burst)	10	VT10	Bonnet - Thermo
1	VP01-22	Safety Assembly - 2250 psi (3750 burst)	11	VP11	Teflon Washer (Handwheel)
1	VP01-24	Safety Assembly - 2400 psi (4000 burst)	12	VP12-BK	Handwheel - Black
1	VP01-27	Safety Assembly - 2730 psi (4550 burst)	12	VP12-GN	Replacement Handwheel - Green
1	VP01-30	Safety Assembly - 3000 psi (5000 burst)	13	VP13	Spring
1	VP01-31	Safety Assembly - 3130 psi (4694 burst)	14	VP14	Nut
1	VP01-33	Safety Assembly - 3300 psi (5500 burst)	<b>15</b>	<b>VP15-V</b>	<b>O-ring - Viton (Outlet)</b>
1	VP01-34	Safety Assembly - 3442 psi (5250 burst)	15	VP15-P	O-ring - Polyurethane (Outlet)
<b>3</b>	<b>VP03-V</b>	<b>O-ring - Viton (3/4"-14 NPSM Inlet)</b>	16	VP16-V	DIN Insert With Both O-rings Viton
4	VT04	Dip Tube - (Pre 10/09) - Fine Threads	17	VP01S-20	Sticker - 2015 psi
4	VP04	Dip Tube - (Post 10/09) - Course Threads	17	VP01S-22	Sticker - 2250 psi
<b>5</b>	<b>VP05</b>	<b>Seat</b>	17	VP01S-24	Sticker - 2400 psi
<b>6</b>	<b>VT06</b>	<b>Copper Crush Washer</b>	17	VP01S-30	Sticker - 3000 psi
7	VP07	Stem	17	VP01S-33	Sticker - 3300 psi
<b>8</b>	<b>VP08-E</b>	<b>O-ring - EPDM (Stem)</b>	17	VP01S-34	Sticker - 3442 psi
<b>9</b>	<b>VP09</b>	<b>Teflon Washer (Stem)</b>	<b>Part numbers in bold italics are standard replacement parts and are included with VKT-P service kit</b>		