

**MK15 HIGH PRESSURE SEAT UPGRADE
NON - ADJUSTABLE STATIONARY SEAT
300 BAR (4350 PSI) PRESSURE RATING**

NOTICE: THIS BULLETIN AFFECTS ALL MK15 FIRST STAGE REGULATORS MANUFACTURED WITH THE ADJUSTABLE INTERMEDIATE PRESSURE FEATURE. THESE ADJUSTABLE REGULATORS CAN BE IDENTIFIED BY THE HEX SLOT IN THE BACK OF THE SEAT RETAINER, AND ARE LIMITED TO A MAXIMUM SERVICE PRESSURE OF 3000 PSI.

THE REDESIGN EMPLOYS A STATIONARY SEAT THAT IS NON-ADJUSTABLE AND RATED TO 300 BAR (4350 PSI) SERVICE.

The new stationary seat design expands the service pressure range of the MK15 to 300 BAR (4350 PSI). This new upgrade will be phased into production and the adjustable feature discontinued. It is identified by the spanner wrench holes in the back of the seat retainer instead of the hex slot. The MK15 has proven to exhibit extremely stable intermediate pressures and makes the adjustment feature unnecessary. The adjustable version MK15's may continue to be used as is, but ONLY if a service pressure of 3000 PSI is not exceeded.

All MK15's should eventually be upgraded to the higher service pressure configuration with the MK15 upgrade kit p/n 10-600-051 (rev. C). This kit does not, however include all of the parts for normal annual service. To upgrade *and* perform annual service, please order the upgrade kit and the annual service kit p/n 10-600-041 (rev. D). Service kits and parts for the previous configuration adjustable MK15 (3000 PSI) will be discontinued. Both kits will be supplied as normal warranty replacement items.

To install the upgrade kit:

- Depressurize the regulator and disassemble the swivel cap.
- Remove the piston (protect sharp edge from damage).
- Unscrew and remove the seat retainer. Discard assembly.
- Remove copper retaining ring, p/n 01-073-112. Discard (new ring supplied)
- Remove white plastic bushing (washer), p/n 10-600-105. Discard
- Properly lubricate O-ring, p/n 01-050-137 (dynamic) with O-ring silicone.
- Install the new brown plastic bushing, p/n 10-600-129.
- Install the new copper retaining ring, p/n 01-073-112.
- Chase the retaining ring with guide tool, p/n 43-300-124, (or suitable device) to ensure proper engagement.
- Reinstall piston.
- Replace swivel cap.
- Install the new seat retainer assembly per diagram on opposite side, drawing 1.
- Tighten the new seat retainer securely and test the intermediate pressure (I.P.).

Cycle the regulator several times by purging the second stage until a stable I.P. is maintained. Correct I.P. is 125 - 145 PSI between 500 and 3000 PSI. If pressure adjustment becomes necessary, 1-3 shims, p/n 01-060-218, may be added or deleted under the spring (body side).

If the pressure is too high and all of the shims have been removed, install the optional spring, p/n 01-020-601, included in the upgrade kit. The 01-020-601 spring is painted red for identification.

(See diagram on reverse)

MK 15 HIGH PRESSURE SEAT UPGRADE KIT

p/n 10-600-051 rev. C

New parts are as follows: see drawing #1

o-ring, seat retainer	01-050-398
seat retainer	10-600-125
seat, h.p.	10-600-123
o-ring, bushing	01-050-401
bushing (chromed metal)	10-600-124
retaining ring (copper)	01-073-112
alignment bushing (brown plastic)	10-600-129
spring, (optional) not shown	01-020-601

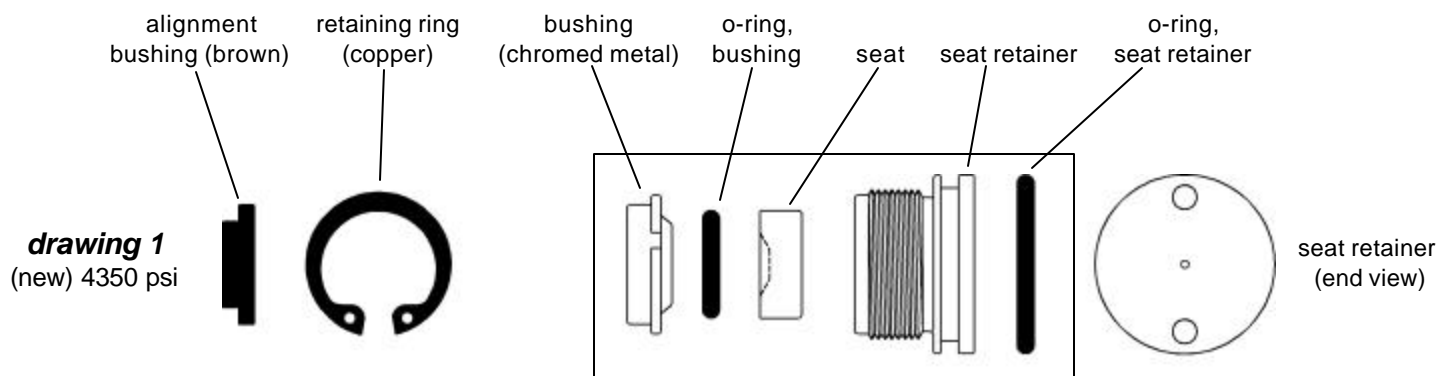

drawing 2
(old) 3000 psi

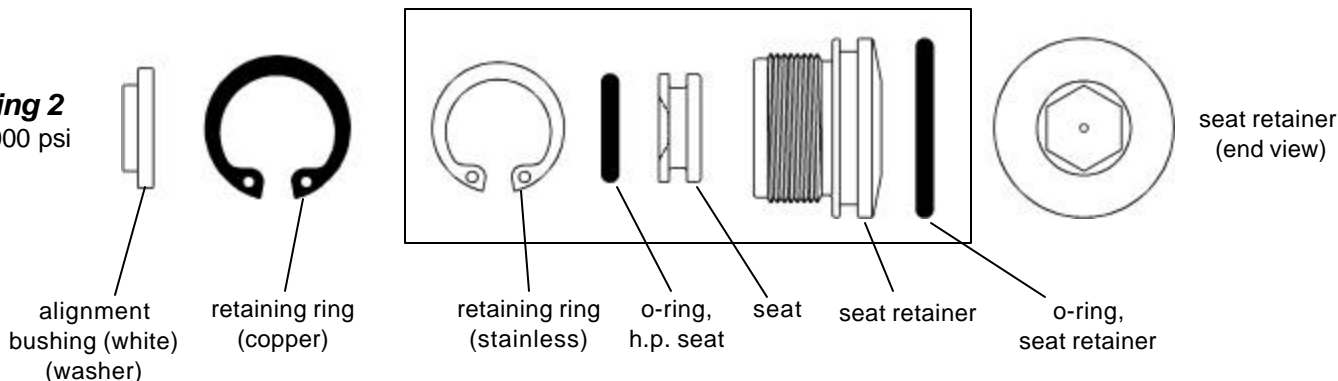

Old parts to be discarded are: see drawing #2

o-ring, seat retainer	01-050-398
seat retainer	10-600-106
seat, h.p.	10-600-122
o-ring, h.p. seat	01-050-142
retaining ring (stainless)	01-073-114
retaining ring (copper)	01-073-112
bushing (white plastic)	10-600-105
decals, 3000 psi	01-006-431