

SCUBAPRO

Technical Service Schematic

MK 10 FIRST STAGE #10-500-000
MK 9 FIRST STAGE #10-400-000

Date 12/97 Revision C
 Annual Repair Parts Kit #10-500-041

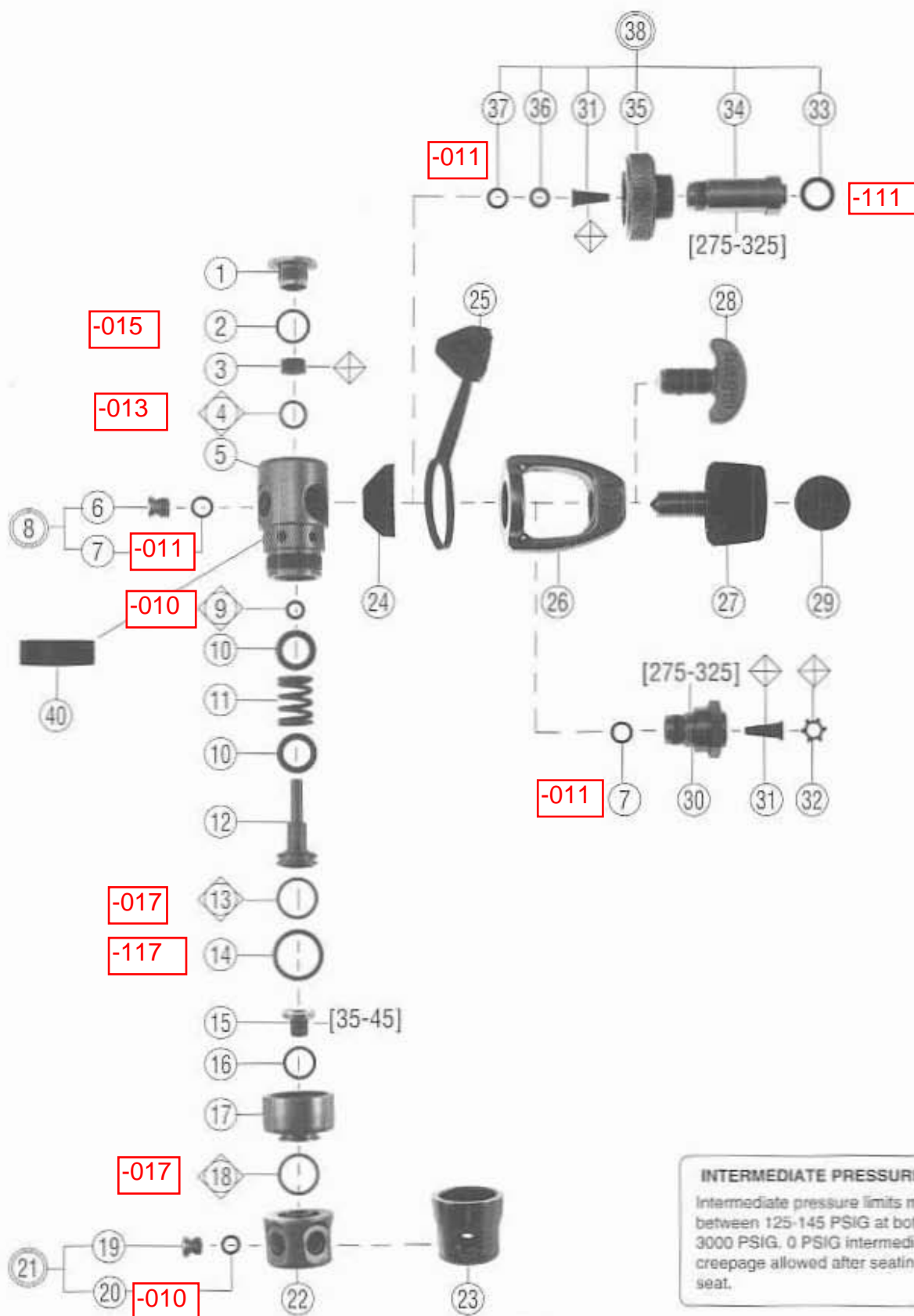

SCUBAPRO

Technical Service Schematic

Parts

| # | QTY | PART # | DESCRIPTION | COST | |
|------------------|-----|------------|----------------------------------|---------------------------------|--|
| 1 | 1 | 10-101-106 | SEAT RETAINER | | |
| 2 | 1 | 01-050-157 | O-RING, SEAT RETAINER, RED | | |
| 3 | 1 | 10-101-151 | SEAT, HP, CAVE CONE | | |
| * 4 | 1 | 01-050-147 | O-RING, HP SEAT, PURPLE | | |
| 5 | 1 | 10-500-108 | BODY, MK10, MK9 | | |
| 6 | 2 | 10-101-139 | HP PLUG, 7/16-20 | | |
| 7 | 3 | 01-050-138 | O-RING, HP PLUG, YOKE RTNR, BLUE | | |
| 8 | 2 | 10-101-039 | HP PLUG, 7/16-20 WITH O-RING | | |
| 9 | 1 | 01-050-137 | O-RING, PISTON SHAFT, AMBER | | |
| * 10 | 3 | 01-060-101 | WASHER | | |
| 11 | 1 | 01-020-217 | SPRING | | |
| 12 | 1 | 10-500-003 | PISTON | | |
| 13 | 1 | 01-050-162 | O-RING, PISTON, LARGE, AMBER | | |
| 14 | 1 | 01-050-217 | O-RING, CAP, BLUE | | |
| 15 | 1 | 0 | 10-500-103 | SWIVEL RETAINER | |
| 16 | 1 | 01-060-500 | WASHER, SWIVEL | | |
| 17 | 1 | 0 | 10-500-101 | CAP, SWIVEL | |
| 18 | 1 | 01-050-161 | O-RING, SWIVEL, BLUE | | |
| 19 | 4 | 4 | 10-101-104 | LP PLUG, 3/8-24 | |
| 20 | 4 | 4 | 01-050-132 | O-RING, LP PLUG, BLUE | |
| 21 | 4 | 4 | 10-101-006 | LP PLUG, 3/8-24 WITH O-RING | |
| 22 | 1 | 0 | 10-500-102 | SWIVEL, 5-PORT | |
| 23 | 0 | 1 | 10-400-105 | CAP, NON SWIVEL, 5-PORT | |
| 24 | 1 | 1 | 10-400-103 | SADDLE | |
| 25 | 1 | 1 | 10-101-211 | HP PROTECTOR | |
| 26 | 1 | 1 | 10-101-131 | YOKE, 9/16, POLISHED | |
| 27 | 1 | 1 | 10-200-008 | YOKE SCREW ASSY, 9/16 | |
| 28 | 1 | 1 | 10-101-132 | YOKE SCREW, 9/16, (OLD STYLE) | |
| 29 | 1 | 0 | 01-006-510 | DECAL, MK10 | |
| 30 | 1 | 1 | 10-400-104 | YOKE RETAINER | |
| 31 | 1 | 1 | 01-028-109 | FILTER, CONICAL | |
| 32 | 1 | 1 | 01-073-101 | FILTER RETAINER | |
| 33 | 1 | 1 | 01-050-193 | O-RING, DIN ADAPTER, BLACK | |
| 34 | 1 | 1 | 10-400-107 | RETAINER, DIN, 300 BAR | |
| 35 | 1 | 1 | 10-105-118 | KNOB, 300 BAR | |
| 36 | 1 | 1 | 01-060-501 | WASHER, DIN | |
| 37 | 1 | 1 | 01-050-142 | O-RING, DIN RETAINER, AMBER | |
| ○ 38 | 1 | 1 | 10-400-030 | KIT, DIN, 300 BAR | |
| ○ 40 | 1 | 1 | 10-500-105 | SPEC BOOT, MK10, MK9 | |
| ○ ● | 1 | 1 | 10-500-020 | SPEC BOOT KIT W/SILICONE GREASE | |
| ○ ● | 1 | 1 | 10-500-021 | E.A.N., CONVERSION KIT (NITROX) | |
| MK10 #10-500-000 | | | | | |
| MK9 #10-400-000 | | | | | |

MK 10 FIRST STAGE #10-500-000
MK 9 FIRST STAGE #10-400-000

Date 12/97 Revision E
 Annual Repair Parts Kit #10-500-041

Technical Information:

Special Engineering Notes:

Item #4, 01-050-147 o-ring can be installed with the aid of a 3/8" nut driver. To properly locate this o-ring, lightly lubricate it, then place it into the body and chase it with the end of the nut driver to fully seat it. Apply a light downward pressure using a rocking action. Remove the nut driver and inspect the o-ring position. It should be located completely into the recess.

Maximum of 3 washers #01-060-101 may be used to adjust intermediate pressure to specified limits.

Flow through piston designs will under some conditions make a whistling noise during flow. To alleviate, replace Item #3 HP seat, and heavily lubricate Item #9, 01-050-137 o-ring.

Legend (prices subject to change without notice)

- Not Shown ◇ Dynamic O'Ring Replace Annually
- Optional Item ◈ Annual Replacement
- ▲ Limited Warranty [] Torque In Inch Pounds
- Older Configuration * See Note